

The Turtle Tube - Gen 2 Grain Rescue Sleeve is part of our Dura Stat brand of stabilization tools and our newest generation of continued product innovation to help rescuers quickly deploy a rescue device during grain entrapment. Made of heavy duty yet flexible and light weight plastic, the Turtle Tube - Gen 2 Grain Rescue Sleeve (U.S. Pat. No. D809,210) is used by rescuers and trainers because it is the lightest, quickest to deploy and most affordable grain rescue device on the market. The Turtle Tube - Gen 2 Grain Rescue Sleeve also works well with other larger rescue tubes/sleeves enabling rescuers to quickly stabilize the patient while building a larger coffer dam.

Scan this code for more resources on this product.



! DANGER	
	RISK OF INJURY OR DEATH This device is a rescue tool and should be used by a trained professional. Failure to comply could lead to injury or death.



Contact us

TURTLE PLASTICS®
7400 Industrial Parkway Drive
Lorain, OH 44053
PH: 800-756-6635 or 440-282-8008
Fax: 800-437-1603 or 440-282-8822
www.turtleplastics.com
orders@turtleplastics.com

ALL TURTLE PLASTICS® PRODUCTS
MADE IN USA



PRODUCT MANUAL

A NEW GENERATION OF LIFE SAVING DEVICE

THE Turtle Tube
Grain Rescue Sleeve™
U.S. Pat. No. D809,210



Introduction

Thank you for choosing the Turtle Tube – Gen 2 Grain Rescue Sleeve as part of your community safety program. At Turtle Plastics, we believe that even one grain entrapment accident is too many. As safety champions for 40 years, we manufacture environmental, health and safety stabilization products used by rescuers, workforce repair technicians and even NASA. Our wide array of Dura Crib, Dura Stat and Turtle Tile brand products are used in many industries including fire/rescue, agriculture, heavy equipment, rail and industrial. All our products are proudly made in the USA.

Care Instructions

- Clean device with mild soap and water. Dry thoroughly after washing and keep device rolled when not in use.
- There are no bolts or metal hinges to lubricate.
- Take care when handling the serrated teeth as they are sharp.
- Store the Turtle Tube - Gen 2 Grain Rescue Sleeve in its carrying bag in a clean and dry environment (you may store vertically or horizontally) and at room/ambient temperature. Because the device is made from a flexible plastic, if stored at a cool temperature, the device will be very difficult to roll and unroll.
- Roll the Turtle Tube - Gen 2 Grain Rescue Sleeve when not in use. A high impact rolling strap is provided to keep the Turtle Tube - Gen 2 Grain Rescue Sleeve in its original rolled shape.
- Inspect Turtle Tube - Gen 2 Grain Rescue Sleeve periodically to ensure all latches are intact and that the overall device is in good working order.
- Train with your device to become familiar with it and entrapment techniques.

Directions for Use

1. This device **is a rescue tool** and **should be used by trained rescue professionals.**
2. Inspect Turtle Tube - Gen 2 Grain Rescue Sleeve for flaws or defects that may jeopardize performance prior to using the device.
3. Assess the situation. Identify obstacles that may affect deployment of the Turtle Tube - Gen 2 Grain Rescue Sleeve.
4. Determine if the Turtle Tube - Gen 2 Grain Rescue Sleeve is the main rescue device for the situation. Locate victim's extremities before inserting panels to avoid injury.
5. After devising a rescue strategy, deploy the Turtle Tube - Gen 2 Grain Rescue Sleeve by removing the device from its carry bag.

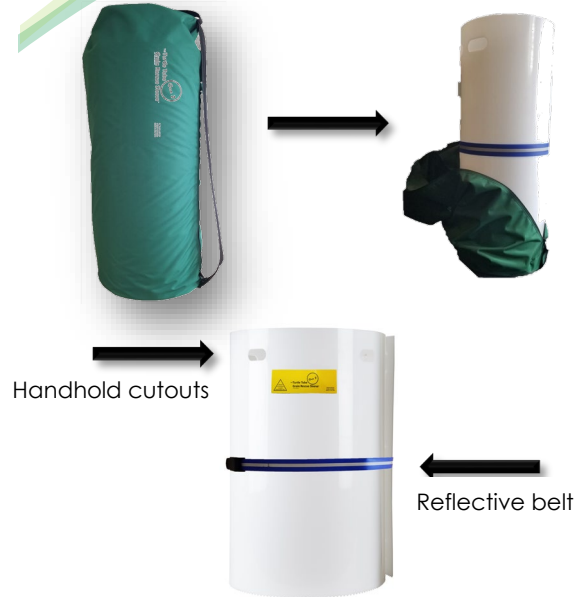

6. Carefully unroll device by unclasp the rolling belt, be careful of the **serrated teeth** at bottom.



7. Create a circular tube by:

- a. Inserting the **first** latch into the first receptacle **C**
- b. Inserting the **second** latch into the second receptacle **B**
- c. Inserting the third latch into the **third** receptacle **A**

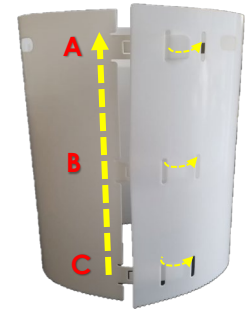

8. Once the Turtle Tube - Gen 2 Grain Rescue Sleeve as its tubular shape and all three self-latches are secured, each responder should stand on either side of the patient and lift the tube over the patient. Use the handhold area to grip the tube to enclose the patient. Begin to work shifting the Turtle Tube - Gen 2 Grain Rescue Sleeve downwards, taking care to leave enough room between the inside walls of the device and the patient's body.
9. Continue bailing grain and pressing the Turtle Tube - Gen 2 Grain Rescue Sleeve downward until victim is freed. The Turtle Tube - Gen 2 Grain Rescue Sleeve can be pressed up to 4' into the grain. Do not remove grain from below the handholds in the bottom of the device; this helps maintain structural integrity of the configuration. Grain may flow in through the bottom handhold; this minuscule amount will not hinder rescue efforts.
10. Remove grain from patient until the patient can be freed by rescuers.
11. When rescue is finished, the Turtle Tube - Gen 2 Grain Rescue Sleeve can be removed and rerolled. Use the enclosed strap to help tighten and secure the device back into its rolled configuration. Always store with serrated teeth at the bottom of the enclosed carry bag.

